



Andy Beshear
GOVERNOR

TRANSPORTATION CABINET

200 Mero Street
Frankfort, Kentucky 40601

Rebecca Goodman
SECRETARY

May 19, 2026

CALL NO. 102
CONTRACT ID NO. 261119
ADDENDUM # 2

Subject: Christian County, STP 5044002
Letting May 21, 2026

- (1) Revised - Completion Date - Cover Page, Page 4 & 17A of 105
- (2) Added - Special Note - Page 40A of 105
- (3) Revised - Proposal Bid Items - Pages 103-105 of 105
- (4) Revised - Plan Sheets - R2B, X004, X005, X006, X011, X012, X013,
X014, R010, X021

Proposal revisions are available at <http://transportation.ky.gov/Construction-Procurement/>.

If you have any questions, please contact us at 502-564-3500.

Sincerely,

A handwritten signature in black ink that reads "Rachel Mills".

Rachel Mills, P.E.
Director
Division of Construction Procurement

RM:so
Enclosures



CALL NO. 102

CONTRACT ID. 261119

CHRISTIAN COUNTY

FED/STATE PROJECT NUMBER STP 5044002

DESCRIPTION LAFAYETTE ROAD(KY 107)

WORK TYPE ASPHALT SURFACE WITH GRADE & DRAIN

PRIMARY COMPLETION DATE 9/18/2027

LETTING DATE: May 21,2026

Sealed Bids will be received electronically through the Bid Express bidding service until 10:00 AM EASTERN DAYLIGHT TIME May 21,2026. Bids will be publicly announced at 10:00 AM EASTERN DAYLIGHT TIME.

PLANS AVAILABLE FOR THIS PROJECT.

DBE CERTIFICATION REQUIRED - 0%

REQUIRED BID PROPOSAL GUARANTY: Not less than 5% of the total bid.

ADMINISTRATIVE DISTRICT - 02

CONTRACT ID - 261119

STP 5044002

COUNTY - CHRISTIAN

PCN - DE02401072619

STP 5044002

LAFAYETTE ROAD(KY 107) IMPROVE SAFETY AND MOBILITY BY WIDENING AND CORRECTING GEOMETRIC DEFICIENCIES ON KY 107 FROM MILEPOINT 15.0 TO MILEPOINT 15.6, A DISTANCE OF 0.60 MILES.ASPHALT SURFACE WITH GRADE & DRAIN SYP NO. 02-80250.10.

GEOGRAPHIC COORDINATES LATITUDE 36:48:59.00 LONGITUDE 87:30:25.00

ADT

COMPLETION DATE(S):

COMPLETED BY 09/18/2027

APPLIES TO ENTIRE CONTRACT

COMPLETED BY 10/30/2026

INTERMEDIATE - SEE SPECIAL NOTE

SPECIAL NOTES FOR FIXED COMPLETION DATES, LIQUIDATED DAMAGES, AND DETOUR/ROAD CLOSURES

Ky 107/Lovers Lane Sight Distance Improvement

Christian County

Item No. 02-80250.10

INTERMEDIATE COMPLETION DATE

All utility work within the contract shall be completed by October 30th, 2026.

FIXED PROJECT COMPLETION DATE

Project completion date is September 18th, 2027.

ROADWAY CONSTRUCTION & SIGNED DETOUR DATES

Signed detour and road closure is to be installed and in effect starting August 10th, 2026. Upon completion of utility work, or no later than the Intermediate Completion Date of October 30th, 2026, the detour signs shall be covered and barricades removed, with all routes open to traffic. No roadway work is allowed from August 10th, 2026, thru April 5th, 2027.

Signed detour may be uncovered and road closure in effect again starting April 5th, 2027, for the start of roadway construction. Detour and road closures shall be removed with all routes open to traffic at the completion of final striping and thermoplastic markings installation.

Contrary to the Construction Sequencing and Phase I notes on Maintenance of Traffic Notes sheet, R024, of the plan set, the above construction and detour notes apply to this contract.

LIQUIDATED DAMAGES

Liquidated Damages in the amount specified in the Standard Specifications, per calendar day, will be assessed for each day the utility work remains incomplete beyond the Intermediate Completion Date listed above.

Liquidated Damages in the amount specified in the Standard Specifications, per calendar day, will be assessed for each day work remains incomplete beyond the Specified Project Completion Date. This project has a Fixed Completion Date of September 18th, 2027.

Also contrary to Section 108, liquidated damages will be charged during the months of December through March.

PREQUALIFIED UTILITY CONTRACTORS

Some utility owners may require contractors that perform relocation work on their respective facilities as a part of the road contract be prequalified or preapproved by the utility owner. **Utility contractors may be added via addendum if KYTC is instructed to do so by the utility owner. Potential contractors must seek prequalification from the utility owner. Any revisions must be sent from the utility owner to KYTC a minimum of one week prior to bid opening.** Those utility owners with a prequalification or preapproval requirement are as follows:

HWEA

- Cleary Construction, Inc.
 - o (270) 487-1784
 - o 2006 Edmonton Road
 - o Tompkinsville, KY 42167

- Scott & Ritter, Inc.
 - o (270) 781-9988
 - o 2385 Barren River Road
 - o Bowling Green, KY 42101

- Infrastructure Systems, Inc.
 - o (812) 865-3309
 - o 260 Vincennes Street
 - o Orleans, IN 47452

- Twin State Utilities, Inc.
 - o (270) 427-5300
 - o P.O. Box 14
 - o Mount Hemon, KY 42157

The bidding contractor needs to review the above list and choose from the list of approved subcontractors as identified above before bidding. When the list of approved subcontractors is provided, only subcontractors shown on the above list(s) will be allowed to work on that utility as a part of this contract. In such instances, the utility subcontractor is not required to be prequalified with the KYTC Division of Construction Procurement.

PROPOSAL BID ITEMS

261119

Page 1 of 3

Report Date 5/18/26

261119

Section: 0001 - PAVING

LINE	BID CODE	ALT	DESCRIPTION	QUANTITY	UNIT	UNIT PRIC	FP	AMOUNT
0010	00003		CRUSHED STONE BASE	4,414.00	TON		\$	
0020	00078		CRUSHED AGGREGATE SIZE NO 2	7,732.00	TON		\$	
0030	00100		ASPHALT SEAL AGGREGATE	37.80	TON		\$	
0040	00103		ASPHALT SEAL COAT	4.50	TON		\$	
0050	00190		LEVELING & WEDGING PG64-22	24.00	TON		\$	
0060	00221		CL2 ASPH BASE 0.75D PG64-22	2,173.00	TON		\$	
0070	00301		CL2 ASPH SURF 0.38D PG64-22	742.00	TON		\$	
0080	02602		FABRIC-GEOTEXTILE CLASS 1	7,664.00	SQYD		\$	
0090	02608		FABRIC-GEOTEXTILE CLASS 4A	7,664.00	SQYD		\$	
0100	20071EC		JOINT ADHESIVE	3,452.00	LF		\$	
0110	20550ND		SAWCUT PAVEMENT	545.00	LF		\$	
0120	21289ED		LONGITUDINAL EDGE KEY	480.00	LF		\$	
0130	24970EC		ASPHALT MATERIAL FOR TACK NON-TRACKING	5.60	TON		\$	
0140	26248EC		ELECTRONIC DELIVERY MGMT SYSTEM - AGG	1.00	LS		\$	

Section: 0002 - ROADWAY

LINE	BID CODE	ALT	DESCRIPTION	QUANTITY	UNIT	UNIT PRIC	FP	AMOUNT
0150	01000		PERFORATED PIPE-4 IN	490.00	LF		\$	
0160	01010		NON-PERFORATED PIPE-4 IN	48.00	LF		\$	
0170	01028		PERF PIPE HEADWALL TY 3-4 IN	4.00	EACH		\$	
0180	02091		REMOVE PAVEMENT	23.00	SQYD		\$	
0190	02159		TEMP DITCH	1,206.00	LF		\$	
0200	02160		CLEAN TEMP DITCH	603.00	LF		\$	
0210	02200		ROADWAY EXCAVATION (REVISED 5-19-26)	11,228.00	CUYD		\$	
0220	02242		WATER	250.00	MGAL		\$	
0230	02429		RIGHT-OF-WAY MONUMENT TYPE 1	19.00	EACH		\$	
0240	02432		WITNESS POST	3.00	EACH		\$	
0250	02483		CHANNEL LINING CLASS II	971.00	TON		\$	
0260	02484		CHANNEL LINING CLASS III	9.00	TON		\$	
0270	02545		CLEARING AND GRUBBING APPROX. 6 ACRES	1.00	LS		\$	
0280	02562		TEMPORARY SIGNS	287.00	SQFT		\$	
0290	02585		EDGE KEY	22.00	LF		\$	
0300	02607		FABRIC-GEOTEXTILE CLASS 2 FOR PIPE	1,781.00	SQYD	\$2.00	\$	\$3,562.00
0310	02650		MAINTAIN & CONTROL TRAFFIC	1.00	LS		\$	
0320	02671		PORTABLE CHANGEABLE MESSAGE SIGN	2.00	EACH		\$	
0330	02676		MOBILIZATION FOR MILL & TEXT	1.00	LS		\$	
0340	02697		EDGELINE RUMBLE STRIPS	4,215.00	LF	\$1.03	\$	\$4,341.45
0350	02701		TEMP SILT FENCE	1,206.00	LF		\$	
0360	02703		SILT TRAP TYPE A	7.00	EACH		\$	

PROPOSAL BID ITEMS

261119

Page 2 of 3

Report Date 5/18/26

LINE	BID CODE	ALT	DESCRIPTION	QUANTITY	UNIT	UNIT PRIC	FP	AMOUNT
0370	02704		SILT TRAP TYPE B	7.00	EACH		\$	
0380	02705		SILT TRAP TYPE C	7.00	EACH		\$	
0390	02706		CLEAN SILT TRAP TYPE A	7.00	EACH		\$	
0400	02707		CLEAN SILT TRAP TYPE B	7.00	EACH		\$	
0410	02708		CLEAN SILT TRAP TYPE C	7.00	EACH		\$	
0420	02726		STAKING	1.00	LS		\$	
0430	02775		ARROW PANEL	2.00	EACH		\$	
0440	05950		EROSION CONTROL BLANKET	3,778.00	SQYD		\$	
0450	05952		TEMP MULCH	20,005.00	SQYD		\$	
0460	05953		TEMP SEEDING AND PROTECTION	15,004.00	SQYD		\$	
0470	05963		INITIAL FERTILIZER	2.20	TON		\$	
0480	05964		MAINTENANCE FERTILIZER	1.10	TON		\$	
0490	05985		SEEDING AND PROTECTION	20,812.00	SQYD		\$	
0500	05992		AGRICULTURAL LIMESTONE	13.00	TON		\$	
0502	06406		SBM ALUM SHEET SIGNS .080 IN (ADDED 5-18-26)	15.25	SQFT		\$	
0504	06407		SBM ALUM SHEET SIGNS .125 IN (ADDED 5-19-26)	12.56	SQFT		\$	
0506	06410		STEEL POST TYPE 1 (ADDED 5-19-26)	58.00	LF		\$	
0510	06515		PAVE STRIPING-PERM PAINT-6 IN	8,863.00	LF		\$	
0520	06568		PAVE MARKING-THERMO STOP BAR-24IN	55.00	LF		\$	
0530	06574		PAVE MARKING-THERMO CURV ARROW	6.00	EACH		\$	
0540	10020NS		FUEL ADJUSTMENT	4,247.00	DOLL	\$1.00	\$	\$4,247.00
0550	20458ES403		CENTERLINE RUMBLE STRIPS	2,034.00	LF		\$	
0552	21813NN		REMOVE AND RELOCATE SHEET SIGNS (ADDED 5-19-26)	4.00	EACH		\$	
0554	24631EC		BARCODE SIGN INVENTORY (ADDED 5-19-26)	2.00	EACH		\$	
0560	24814EC		PIPELINE INSPECTION	359.00	LF		\$	

Section: 0003 - DRAINAGE

LINE	BID CODE	ALT	DESCRIPTION	QUANTITY	UNIT	UNIT PRIC	FP	AMOUNT
0570	00441		ENTRANCE PIPE-18 IN	288.00	LF		\$	
0580	00464		CULVERT PIPE-24 IN	161.00	LF		\$	
0590	00466		CULVERT PIPE-30 IN	54.00	LF		\$	
0600	01451		S & F BOX INLET-OUTLET-24 IN	3.00	EACH		\$	
0610	01452		S & F BOX INLET-OUTLET-30 IN	2.00	EACH		\$	
0620	01490		DROP BOX INLET TYPE 1	1.00	EACH		\$	

Section: 0004 - WATERLINE

LINE	BID CODE	ALT	DESCRIPTION	QUANTITY	UNIT	UNIT PRIC	FP	AMOUNT
0630	02690		SAFELOADING	8.00	CUYD		\$	
0640	14001		W AIR RELEASE VALVE 3/4 INCH	1.00	EACH		\$	
0650	14003		W CAP EXISTING MAIN	3.00	EACH		\$	
0660	14010		W ENCASEMENT STEEL BORED RANGE 5 24 INCH	85.00	LF		\$	

PROPOSAL BID ITEMS

261119

Page 3 of 3

Report Date 5/18/26

LINE	BID CODE	ALT	DESCRIPTION	QUANTITY	UNIT	UNIT PRIC	FP	AMOUNT
0670	14019		W FIRE HYDRANT ASSEMBLY	2.00	EACH		\$	
0680	14025		W METER 1 INCH	1.00	EACH		\$	
0690	14027		W METER 2 INCH	1.00	EACH		\$	
0700	14039		W PIPE DUCTILE IRON 12 INCH	852.00	LF		\$	
0710	14050		W PIPE DCTL IRON RSTRND JOINT 12 IN	1,036.00	LF		\$	
0720	14077		W SERV PE/PLST LONG SIDE 1 IN	1.00	EACH		\$	
0730	14079		W SERV PE/PLST LONG SIDE 2 IN	1.00	EACH		\$	
0740	14080		W SERV PE/PLST LONG SIDE 3/4 IN	6.00	EACH		\$	
0750	14085		W SERV PE/PLST SHORT SIDE 3/4 IN	2.00	EACH		\$	
0760	14090		W TAPPING SLEEVE AND VALVE SIZE 2	3.00	EACH		\$	
0770	14108		W VALVE 12 INCH	3.00	EACH		\$	
0780	14124		W VALVE SPECIAL	3.00	EACH		\$	
0790	14144		W LINE MARKER	4.00	EACH		\$	
0800	14182		W METER 5/8 INCH	7.00	EACH		\$	
0810	23967EC		ASPHALT DRIVEWAY/PARKING LOT REPLACEMENT	50.00	LF		\$	

Section: 0005 - DEMOBILIZATION &/OR MOBILIZATION

LINE	BID CODE	ALT	DESCRIPTION	QUANTITY	UNIT	UNIT PRIC	FP	AMOUNT
0820	02568		MOBILIZATION	1.00	LS		\$	
0830	02569		DEMOBILIZATION	1.00	LS		\$	

ITEM	DESCRIPTION	NOTE(S)	UNIT	KY 107	LOVER'S LANE														TOTAL PROJECT
02091	REMOVE PAVEMENT		SQYD	23															23
02159	TEMP DITCH		LF	1206															1206
02160	CLEAN TEMP DITCH		LF	603															603
02200	ROADWAY EXCAVATION	1	CUYD	10503	725														11228
02242	WATER	2	MGAL	290															290
02429	RIGHT-OF-WAY MONUMENT TYPE 1		EACH	15	4														19
02432	WITNESS POST		EACH	3															3
02483	CHANNEL LINING CLASS II		TON	971															971
02484	CHANNEL LINING CLASS III	5	TON	9															9
02545	CLEARING AND GRUBBING	3	LS	1															1
02562	TEMPORARY SIGNS		SQFT	287															287
02568	MOBILIZATION		LS	1															1
02569	DEMOBILIZATION		LS	1															1
02585	EDGE KEY		LF	22															22
02607	FABRIC-GEOTEXTILE CLASS 2 FOR PIPE	4	SQYD	1427	354														1781
02650	MAINTAIN & CONTROL TRAFFIC		LS	1															1
02671	PORTABLE CHANGEABLE MESSAGE SIGN		EACH	2															2
02676	MOBILIZATION FOR MILL & TEXT		LS	1															1
02697	EDGE LINE RUMBLE STRIPS		LF	4215															4215
02701	TEMP SILT FENCE		LF	1206															1206
02703	SILT TRAP TYPE A		EACH	7															7
02704	SILT TRAP TYPE B		EACH	7															7
02705	SILT TRAP TYPE C		EACH	7															7
02706	CLEAN SILT TRAP TYPE A		EACH	7															7
02707	CLEAN SILT TRAP TYPE B		EACH	7															7
02708	CLEAN SILT TRAP TYPE C		EACH	7															7
02726	STAKING		LS	1															1
02775	ARROW PANEL		EACH	2															2
05950	EROSION CONTROL BLANKET		SQYD	2585	1193														3778
05952	TEMP MULCH		SQYD	20005															20005
05953	TEMP SEEDING AND PROTECTION		SQYD	15004															15004
05963	INITIAL FERTILIZER		TON	2.2															2.2
05964	MAINTENANCE FERTILIZER		TON	1.1															1.1
05985	SEEDING AND PROTECTION		SQYD	20812															20812
05992	AGRICULTURAL LIMESTONE		TON	13															13
06515	PAVE STRIPING-PERM PAINT-6 IN		LF	8863															8863
06568	PAVE MARKING-THERMO STOP BAR-24IN		LF	55															55
06574	PAVE MARKING-THERMO CURV ARROW		EACH	6															6
10020NS	FUEL ADJUSTMENT		DOLL	4247															4247
20458ES403	CENTERLINE RUMBLE STRIPS		LF	2034															2034
24814EC	PIPELINE INSPECTION		LF	258	101														359
06406	SBM ALUM SHEET SIGNS .080 IN		SQFT	15.25															15.25
06407	SBM ALUM SHEET SIGNS .125 IN		SQFT	12.56															12.56
06410	STEEL POST TYPE 1		LF	58															58
21813NN	REMOVE AND RELOCATE SHEET SIGNS		EACH	4															4
24631EC	BARCODE SIGN INVENTORY		EACH	2															2

- ① THE CONTRACTOR IS ADVISED THAT THE TOTAL EARTHWORK QUANTITIES SHOWN ARE FOR INFORMATIONAL PURPOSES ONLY. ASSUMPTIONS FOR SHRINKAGE AND SWELL FACTORS ARE THE RESPONSIBILITY OF THE CONTRACTOR.
- ② FOR CONTROLLING DUST CAUSED BY MAINTAINING TRAFFIC ONLY.
- ③ APPROXIMATELY 6.2 AC.
- ④ FOR WRAPPING PIPE TRENCH BACKFILL.
- ⑤ 9 TONS OF CHANNEL LINING CLASS III FROM DRAINAGE SUMMARY

EARTHWORK CALCULATIONS	
EMBANKMENT:	
EMB. - 1,442 CUYD	
EMB. BENCH - 505 CUYD	
PVMT. RMVL. - 398 CUYD	
TOTAL EMB. - 2,345 CUYD	
EXCAVATION:	
COM. - 10,325 CUYD	
EMB. BENCH - 505 CUYD	
PVMT. RMVL. - 398 CUYD	
TOTAL EXC. - 11,228 CUYD	
EARTHWORK TOTALS	
EXC. AVAILABLE: 8,883 CUYD	

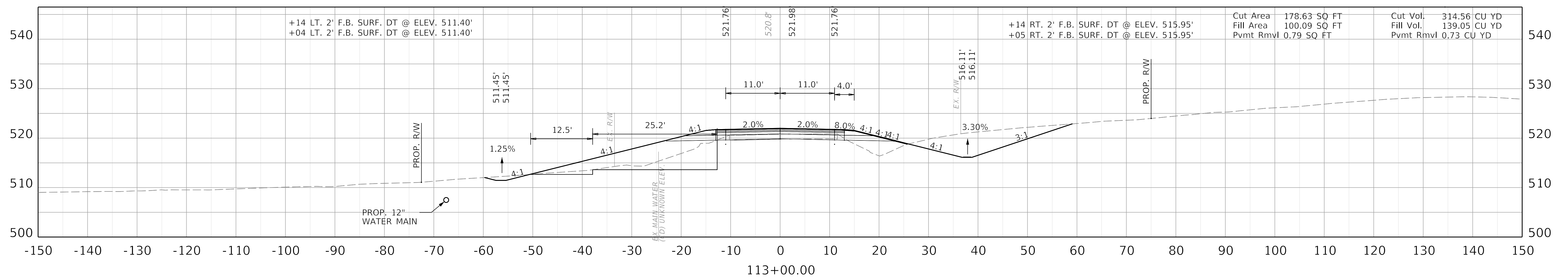
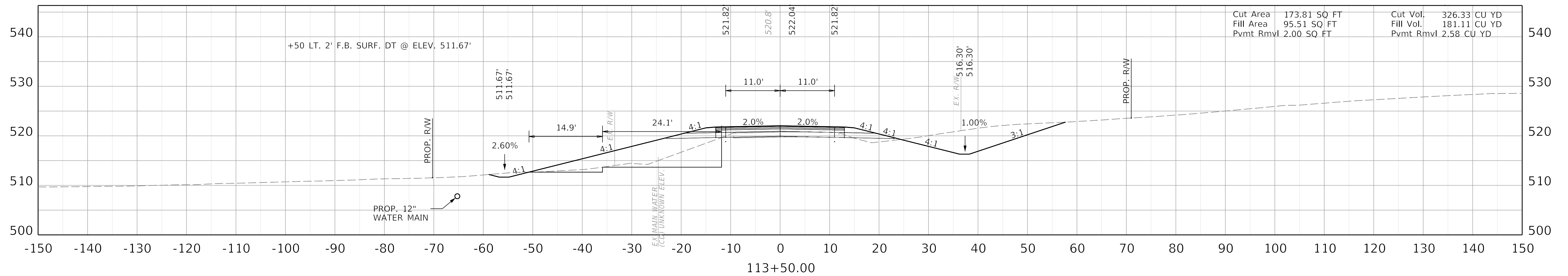
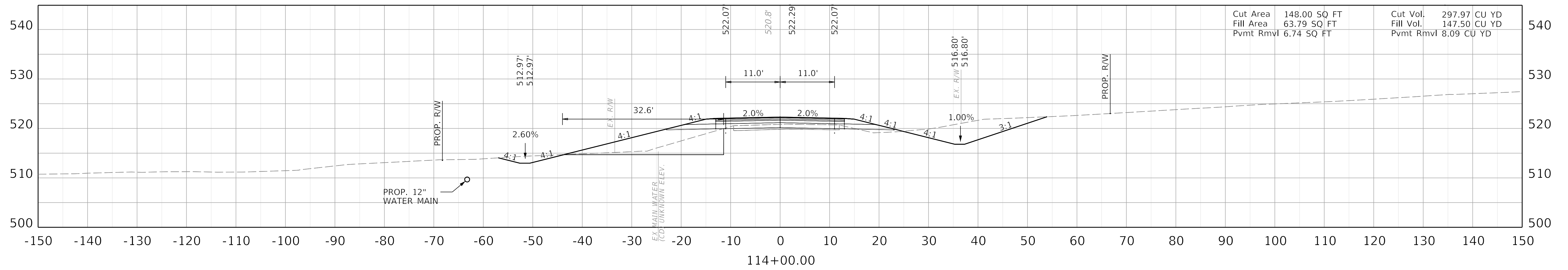

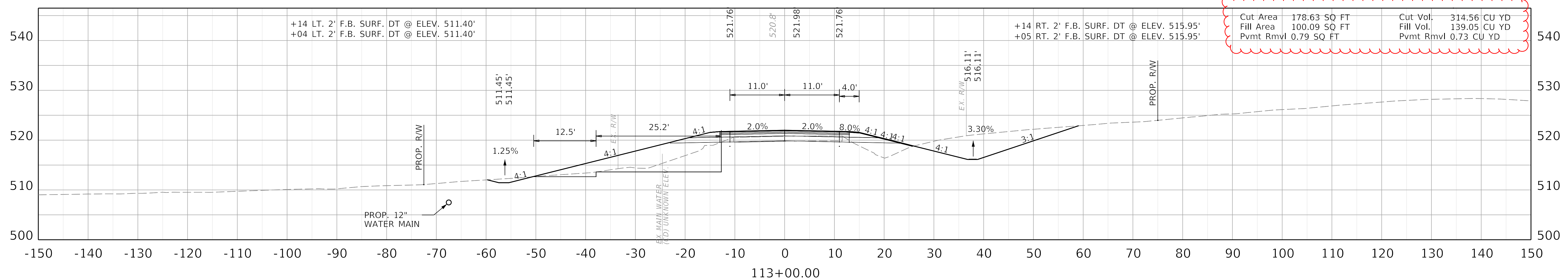
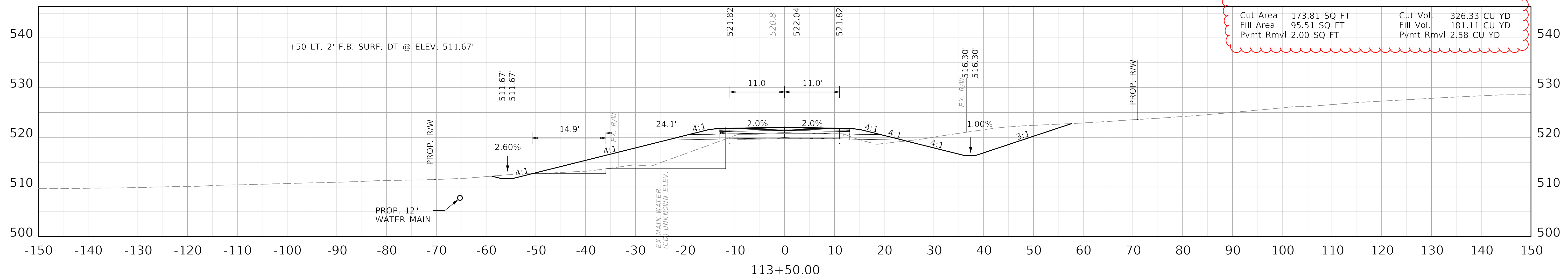
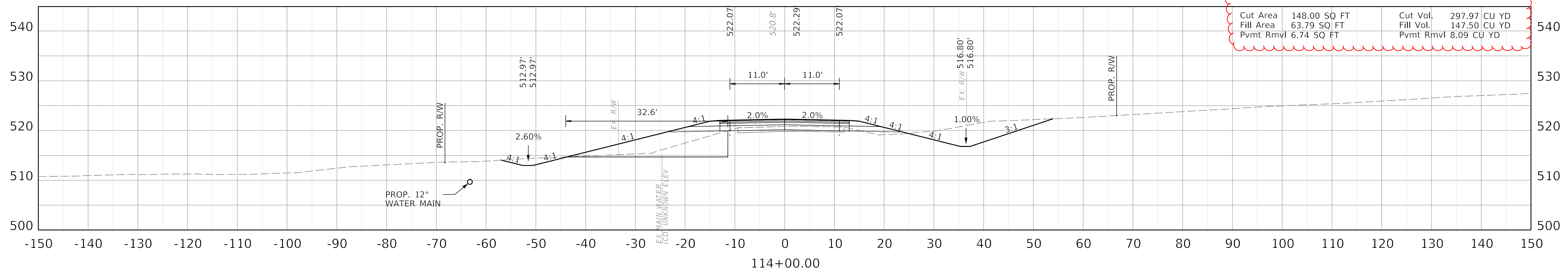

COMMONWEALTH OF KENTUCKY
DEPARTMENT OF HIGHWAYS

DRAWING TITLE: KY 107 CROSS SECTIONS

HORIZONTAL SCALE
SCALE: 1" = 10'



STA 113+00.00 TO STA 114+00.00

ITEM NO. 02-80250.10 COUNTY OF CHRISTIAN
SHEET NO. X004

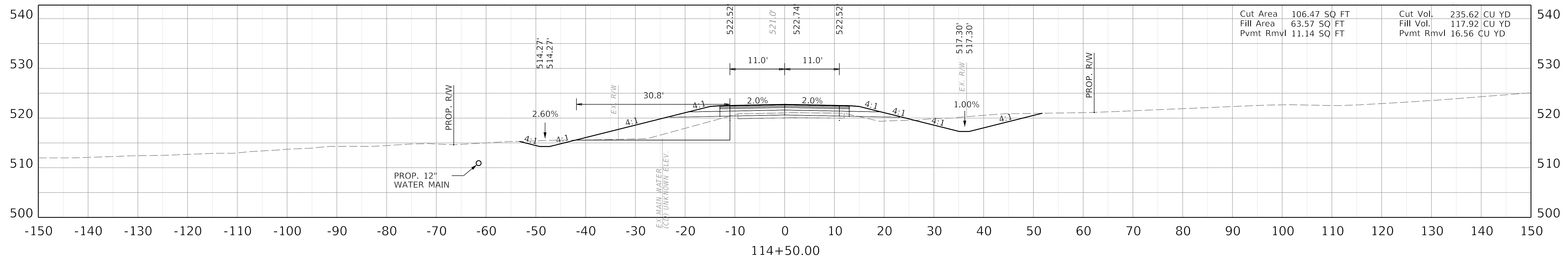
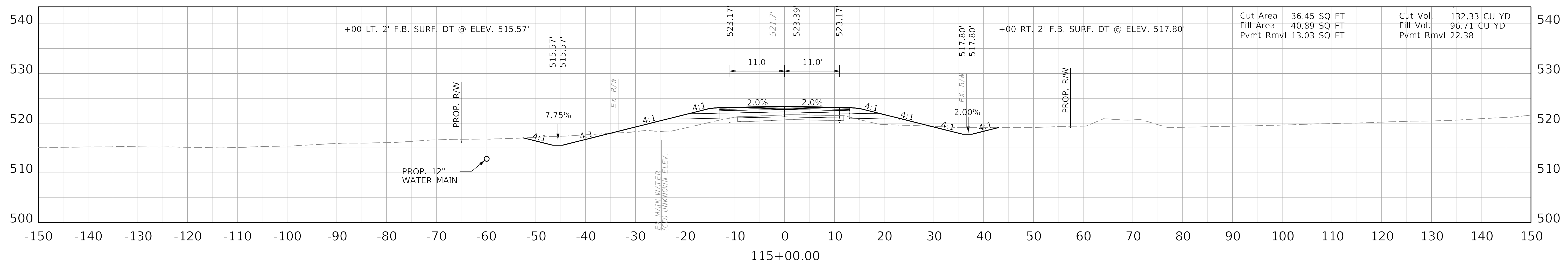
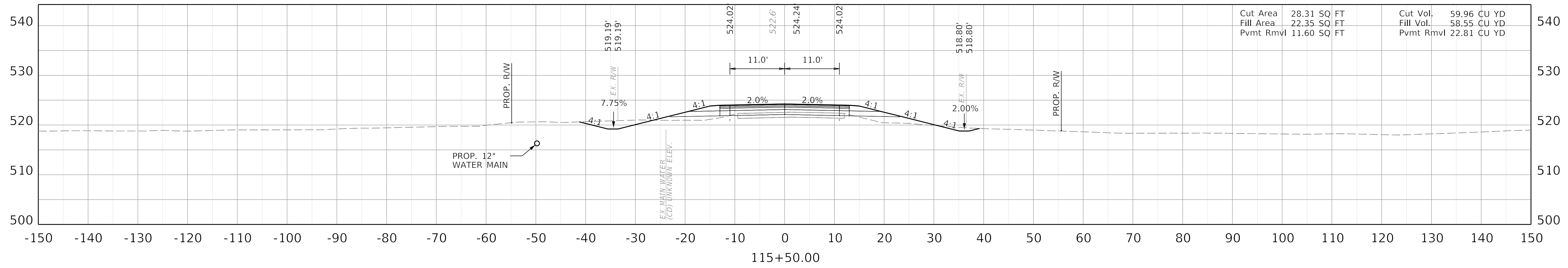

COMMONWEALTH OF KENTUCKY
DEPARTMENT OF HIGHWAYS

DRAWING TITLE: KY 107 CROSS SECTION

HORIZONTAL SCALE
SCALE: 1" = 10'



STA 114+50.00 TO STA 115+50.00

ITEM NO. 02-80250.10 COUNTY OF CHRISTIAN
SHEET NO. X005

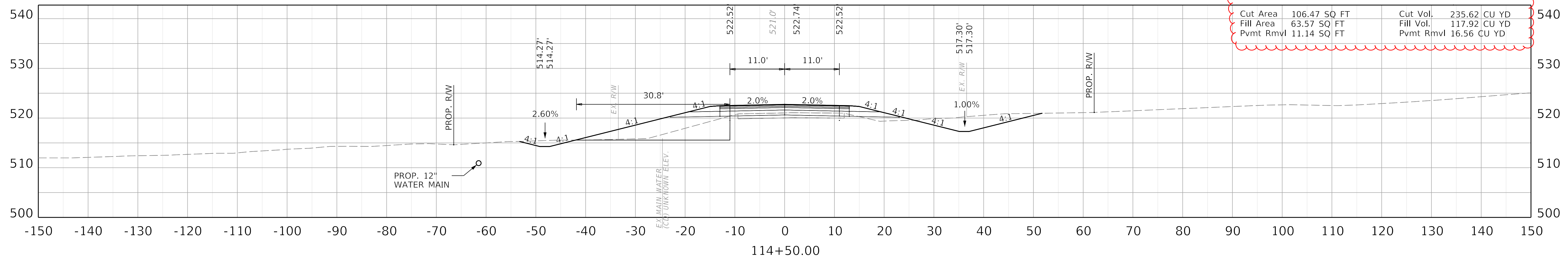
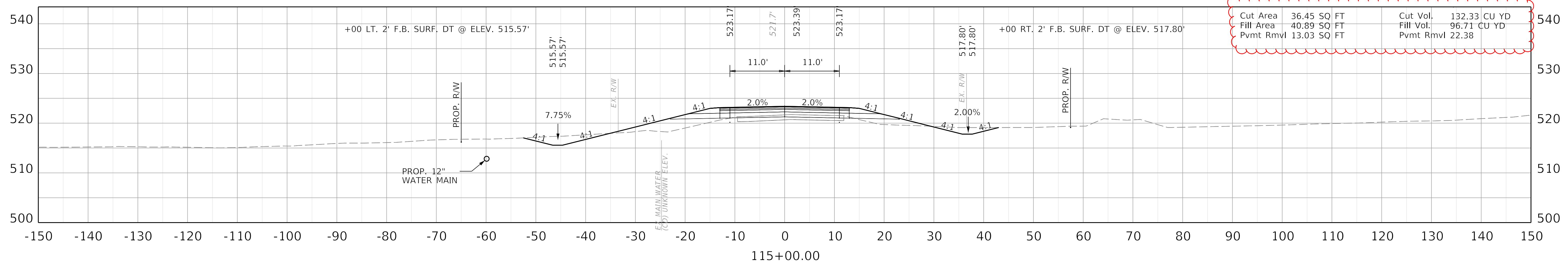
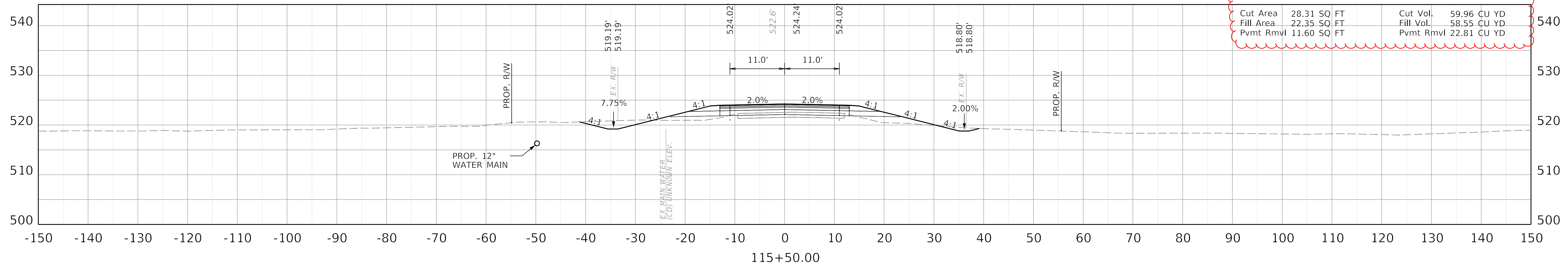

COMMONWEALTH OF KENTUCKY
DEPARTMENT OF HIGHWAYS

DRAWING TITLE: KY 107 CROSS SECTION

HORIZONTAL SCALE
SCALE: 1" = 10'



STA 114+50.00 TO STA 115+50.00

ITEM NO. 02-80250.10 COUNTY OF CHRISTIAN

SHEET NO. X005

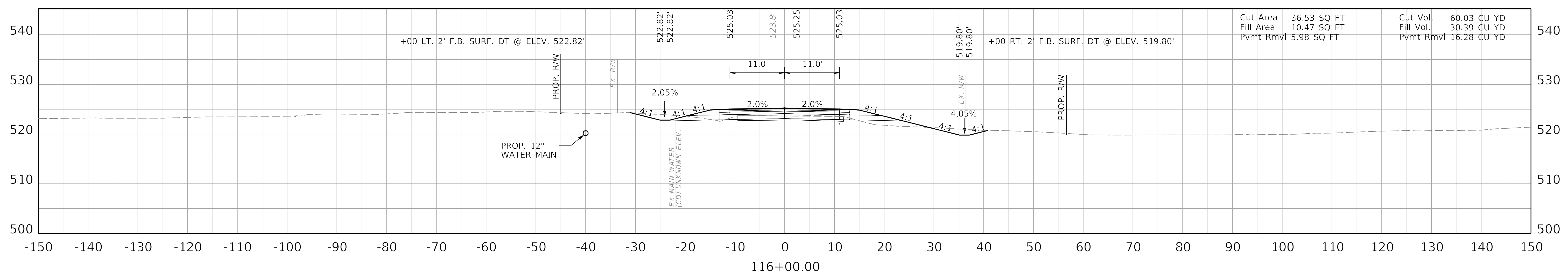
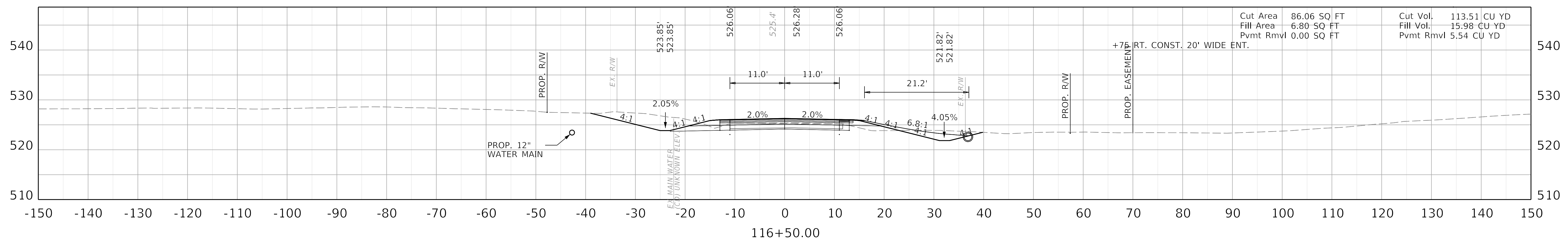
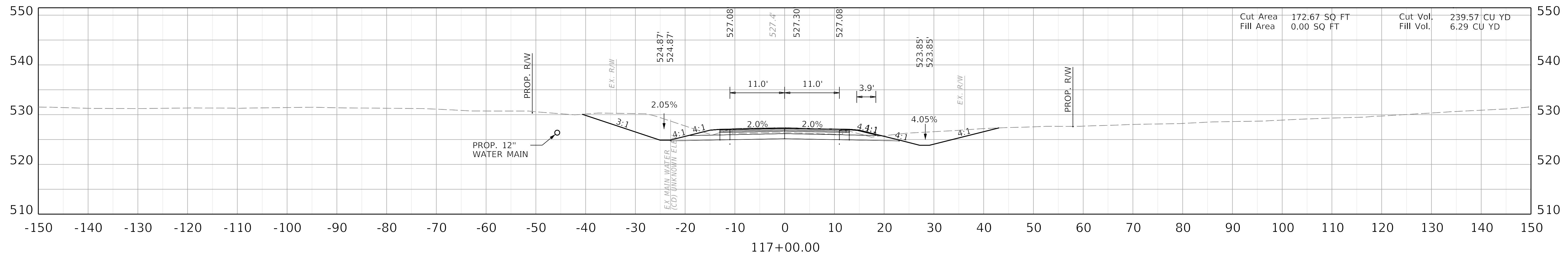

COMMONWEALTH OF KENTUCKY
DEPARTMENT OF HIGHWAYS

DRAWING TITLE: KY 107 CROSS SECTIONS

HORIZONTAL SCALE
SCALE: 1" = 10'



STA 116+00.00 TO STA 117+00.00

ITEM NO. 02-80250.10 COUNTY OF CHRISTIAN
SHEET NO. X006

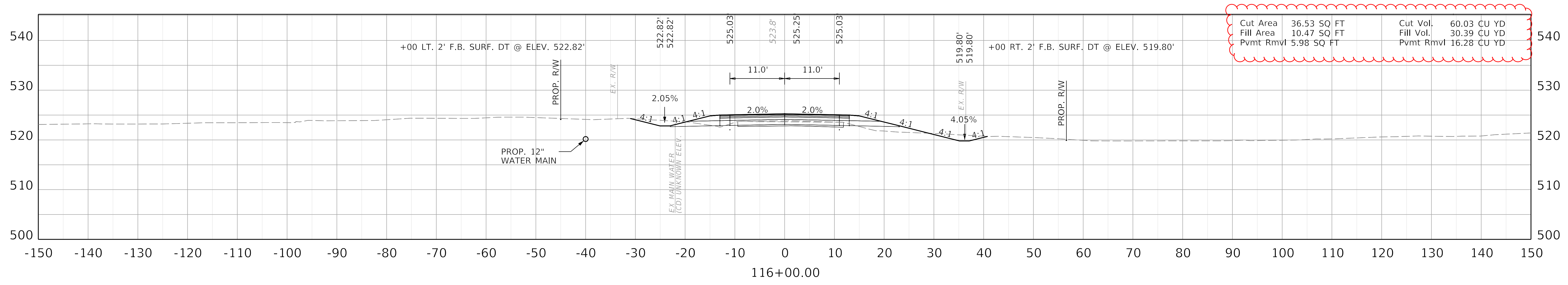
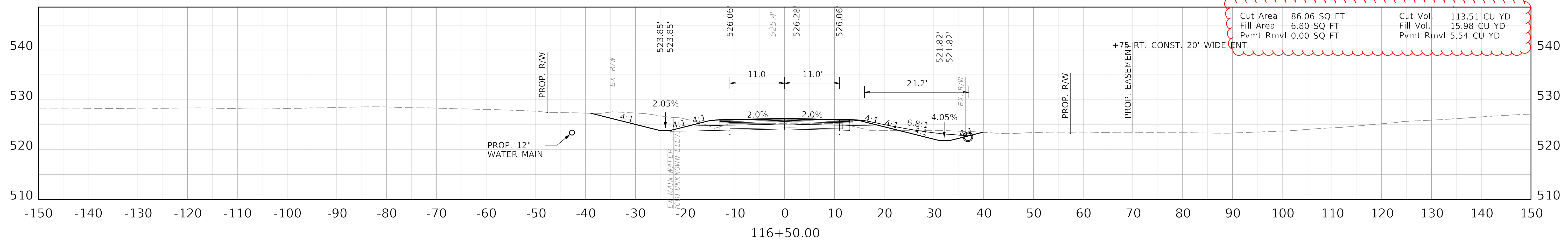
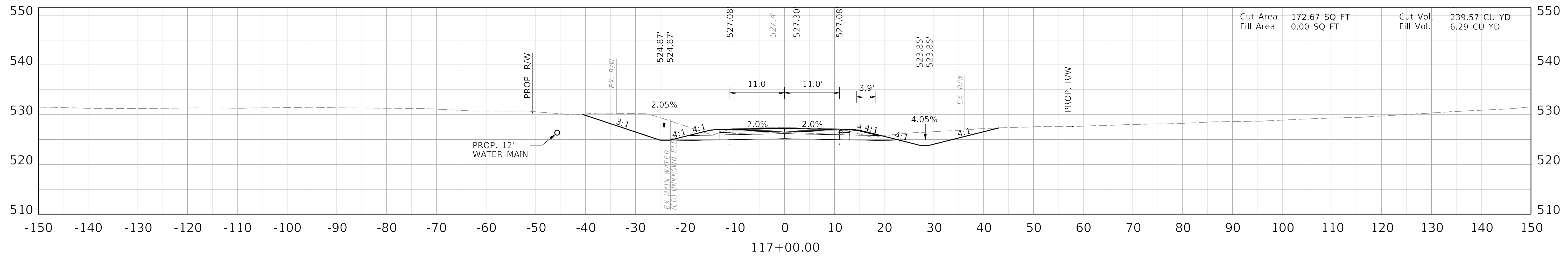

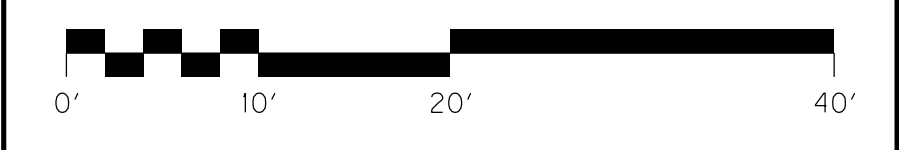
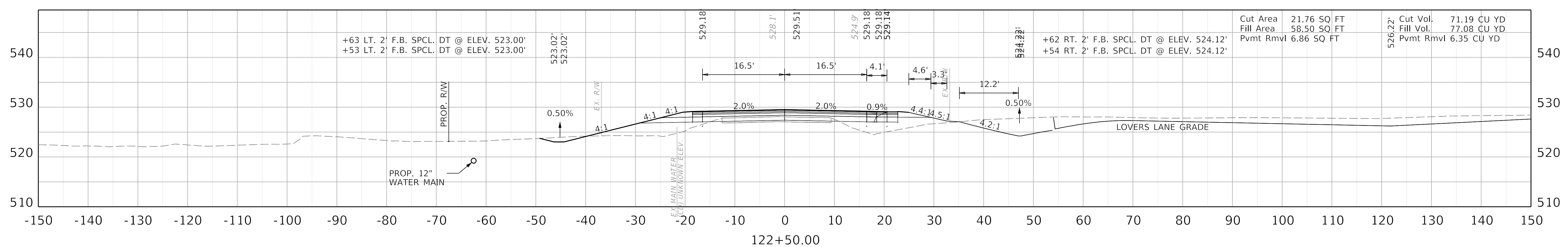
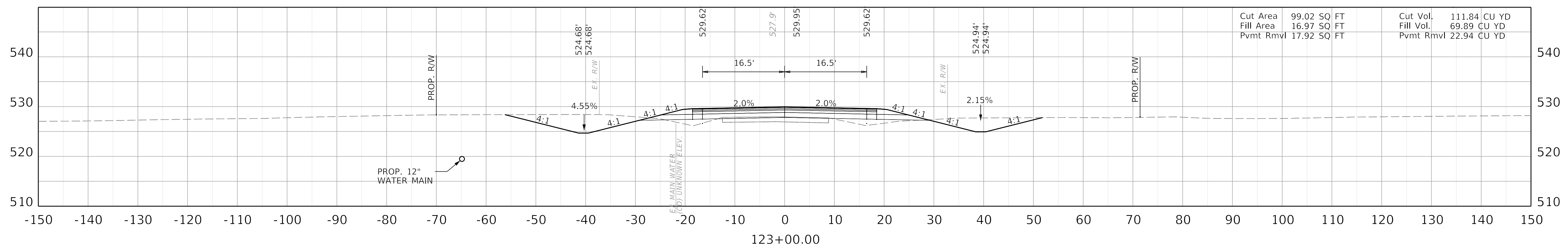
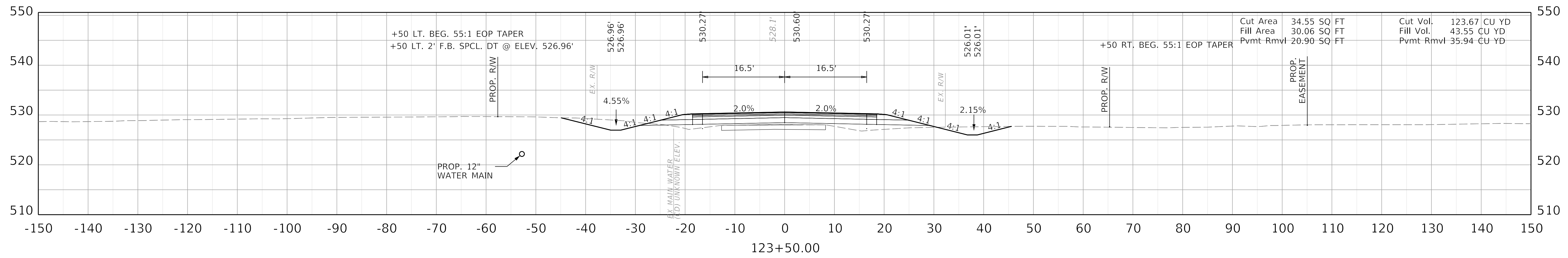

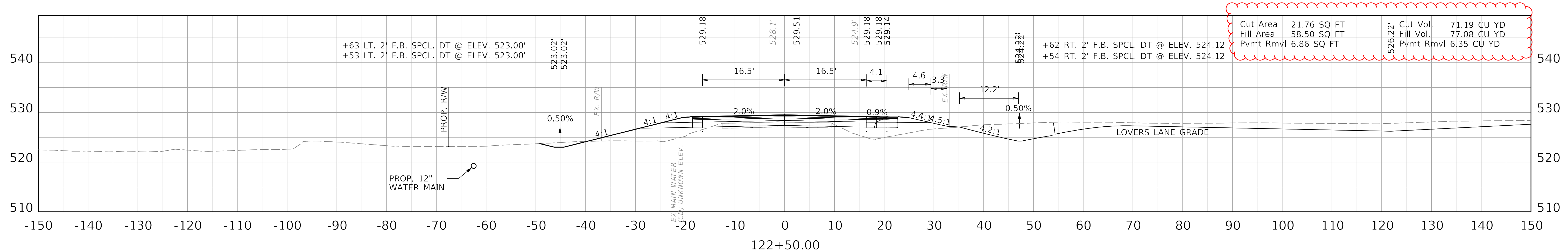
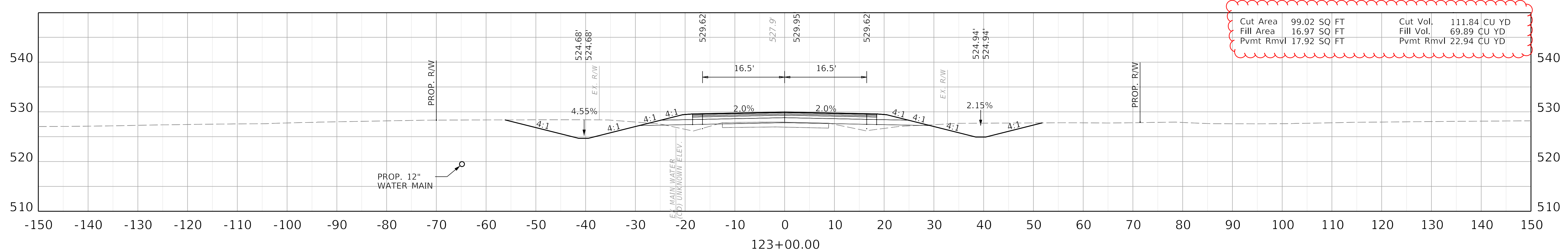
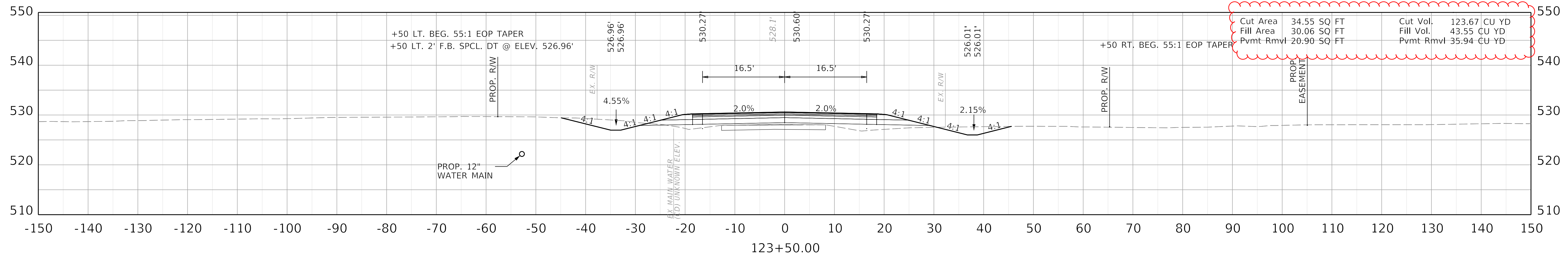

COMMONWEALTH OF KENTUCKY
DEPARTMENT OF HIGHWAYS

DRAWING TITLE: KY 107 CROSS SECTIONS

HORIZONTAL SCALE
SCALE: 1" = 10'

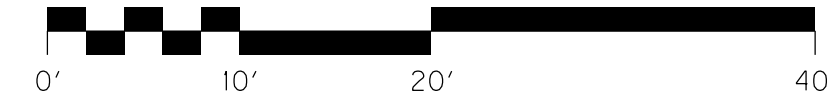

STA 122+50.00 TO STA 123+50.00

ITEM NO. 02-80250.10 COUNTY OF CHRISTIAN
SHEET NO. X011

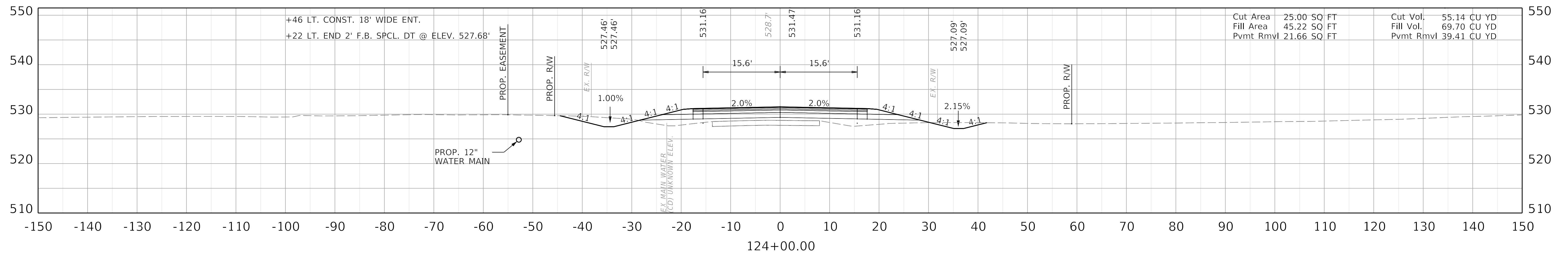
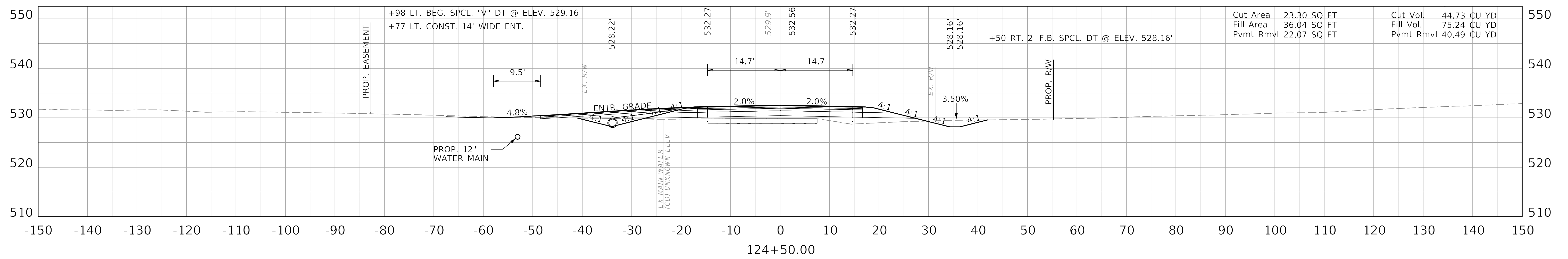
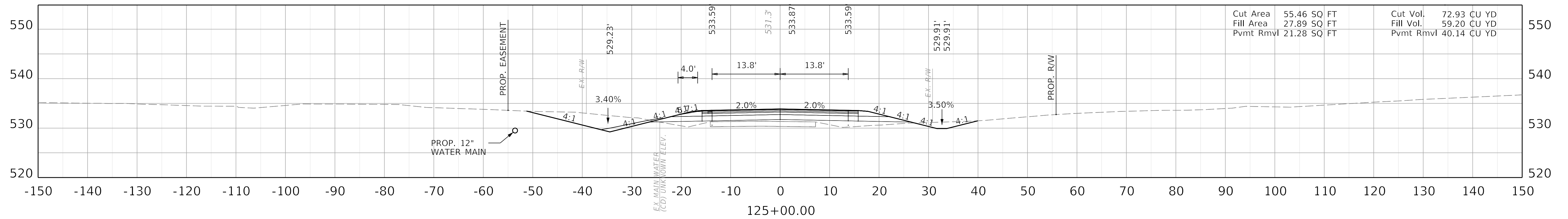

COMMONWEALTH OF KENTUCKY
DEPARTMENT OF HIGHWAYS

DRAWING TITLE: KY 107 CROSS SECTIONS

HORIZONTAL SCALE
SCALE: 1" = 10'

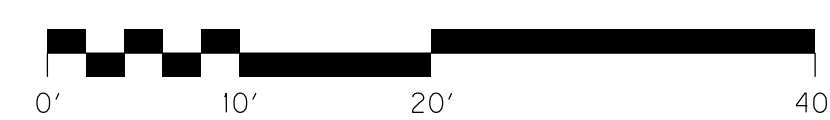

STA 124+00.00 TO STA 125+00.00

ITEM NO. 02-80250.10 COUNTY OF CHRISTIAN
SHEET NO. X012

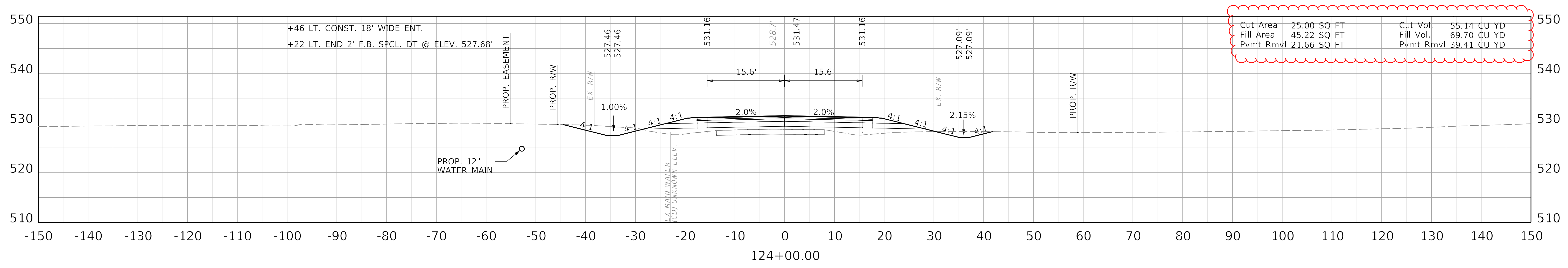
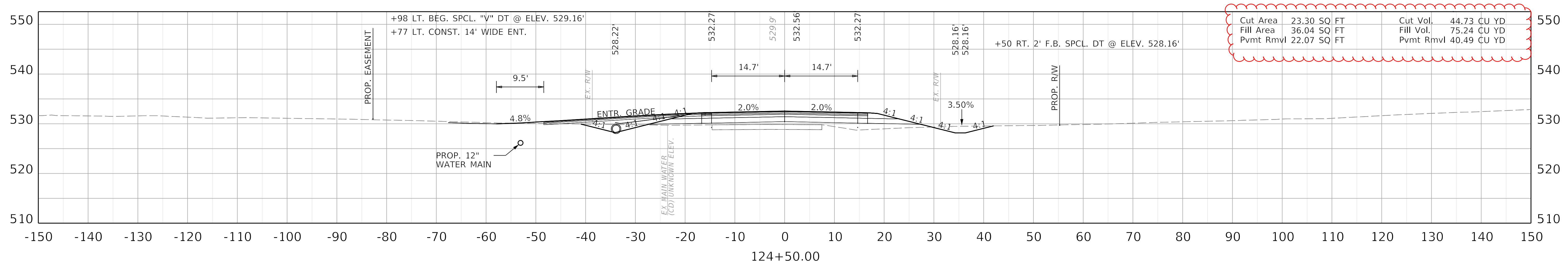
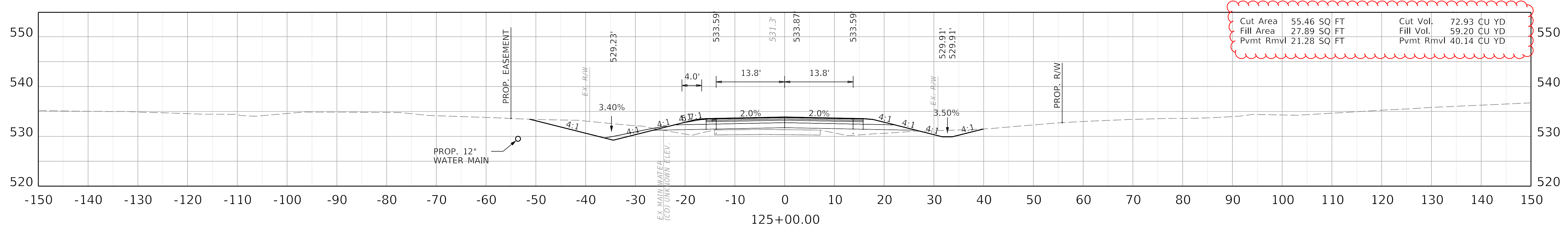

COMMONWEALTH OF KENTUCKY
DEPARTMENT OF HIGHWAYS

DRAWING TITLE: KY 107 CROSS SECTIONS

HORIZONTAL SCALE
SCALE: 1" = 10'



STA 124+00.00 TO STA 125+00.00

ITEM NO. 02-80250.10 COUNTY OF CHRISTIAN

SHEET NO. X012

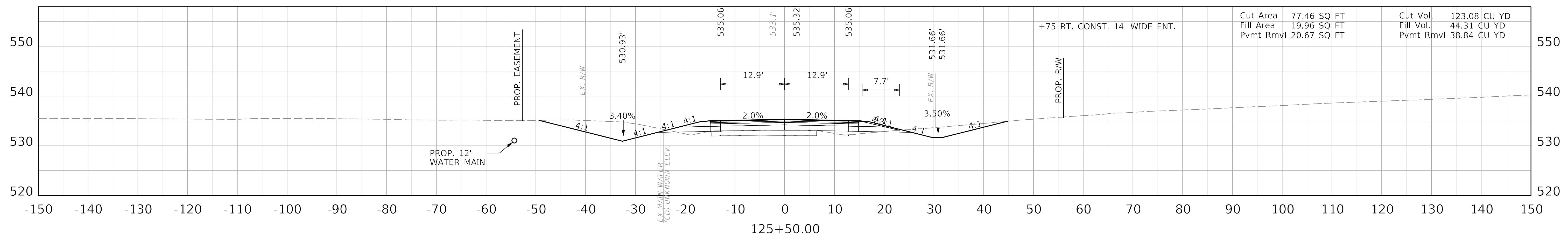
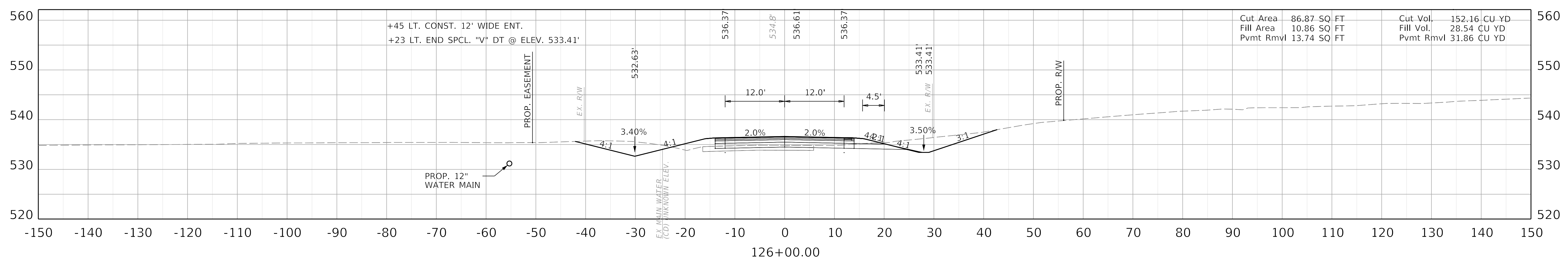
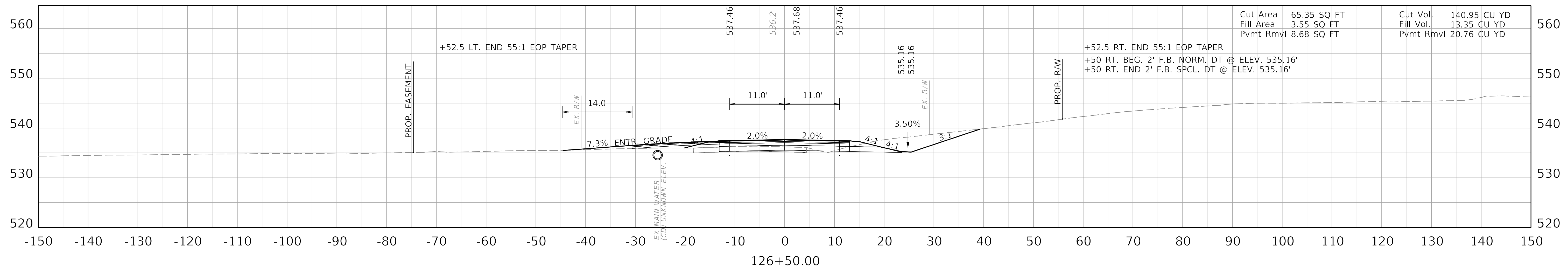

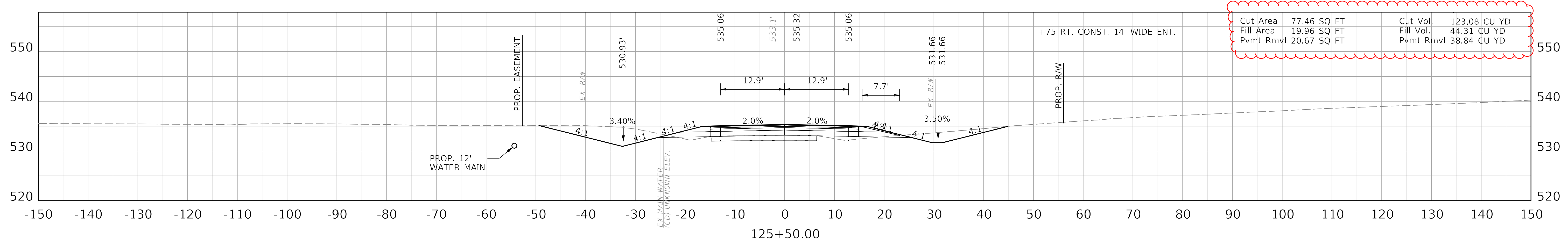
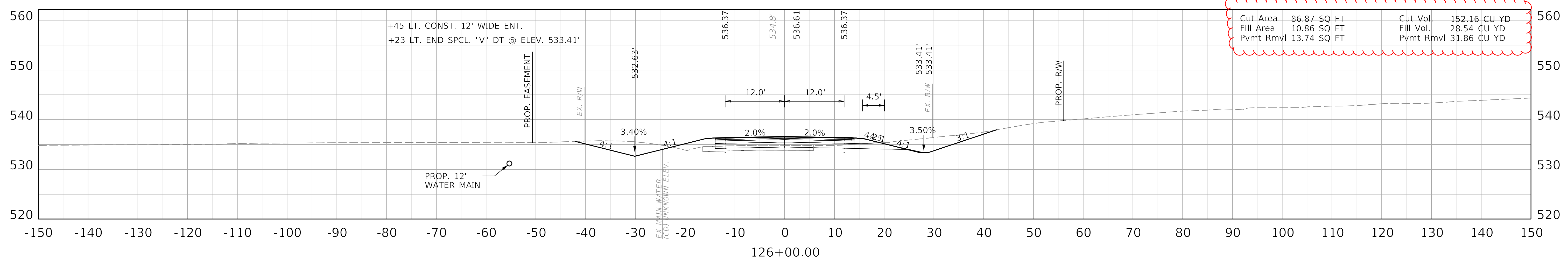
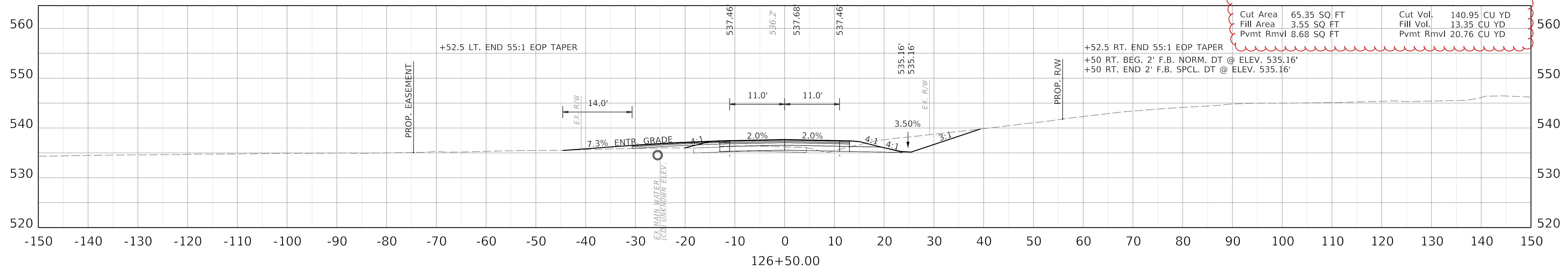

COMMONWEALTH OF KENTUCKY
DEPARTMENT OF HIGHWAYS

DRAWING TITLE: KY 107 CROSS SECTIONS

HORIZONTAL SCALE
SCALE: 1" = 10'



STA 125+50.00 TO STA 126+50.00

ITEM NO. 02-80250.10 COUNTY OF CHRISTIAN
SHEET NO. X013

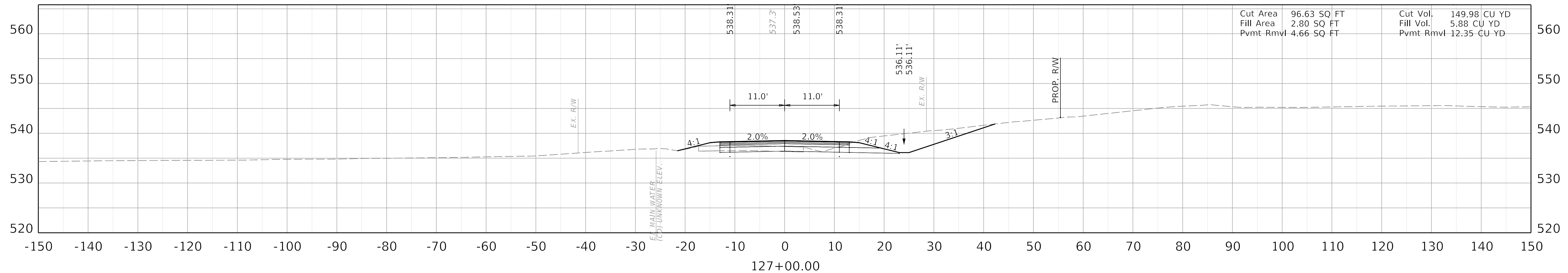
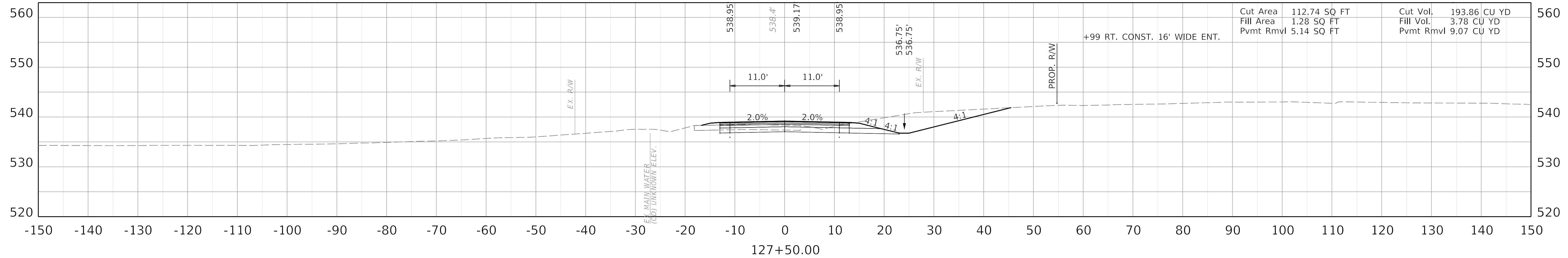
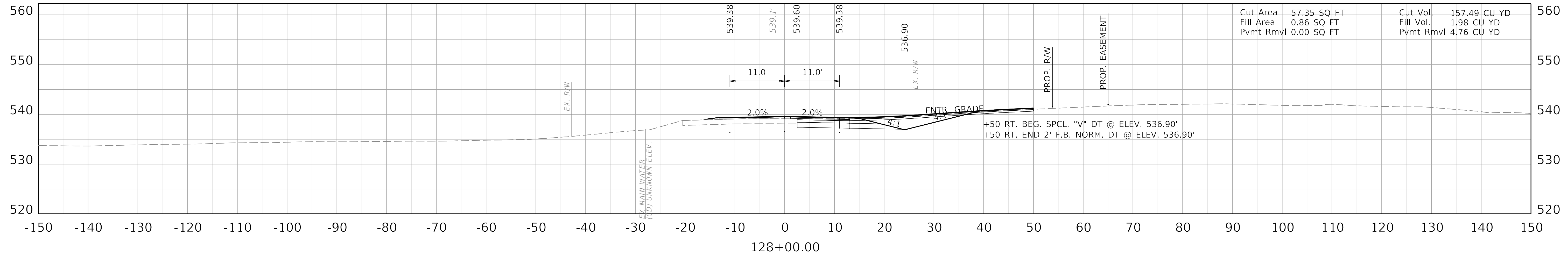

COMMONWEALTH OF KENTUCKY
DEPARTMENT OF HIGHWAYS

DRAWING TITLE: KY 107 CROSS SECTIONS

HORIZONTAL SCALE
SCALE: 1" = 10'



STA 127+00.00 TO STA 128+00.00

ITEM NO. 02-80250.10 COUNTY OF CHRISTIAN
SHEET NO. X014

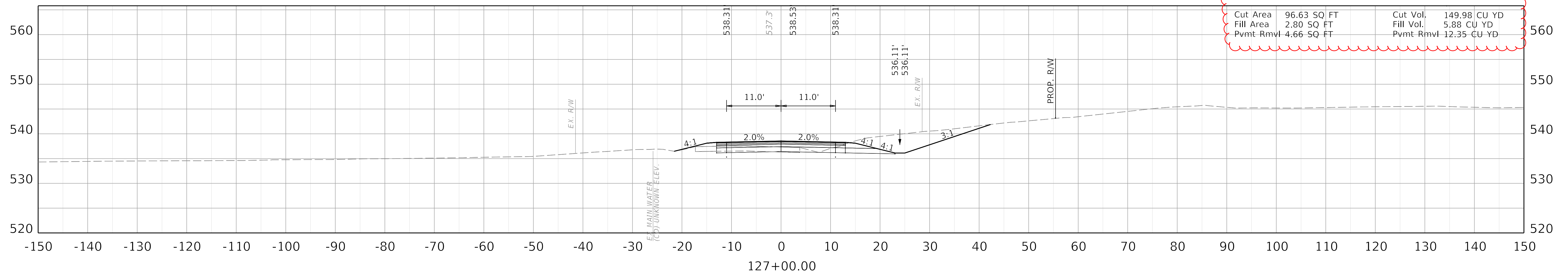
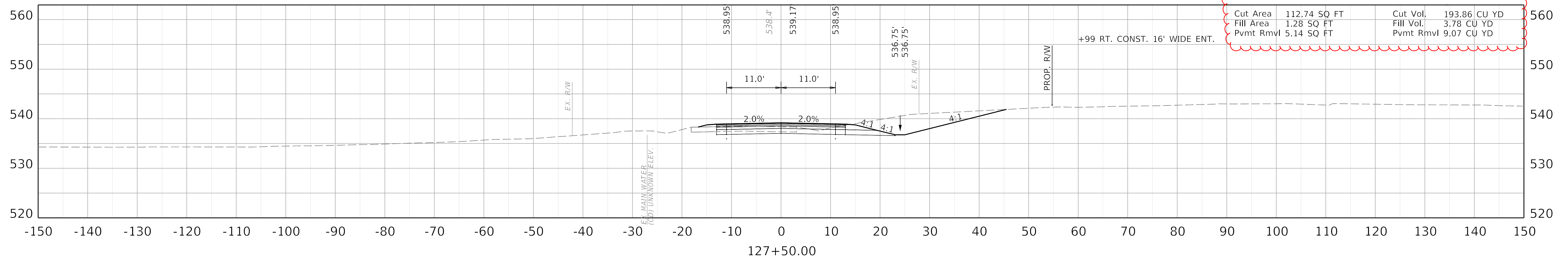
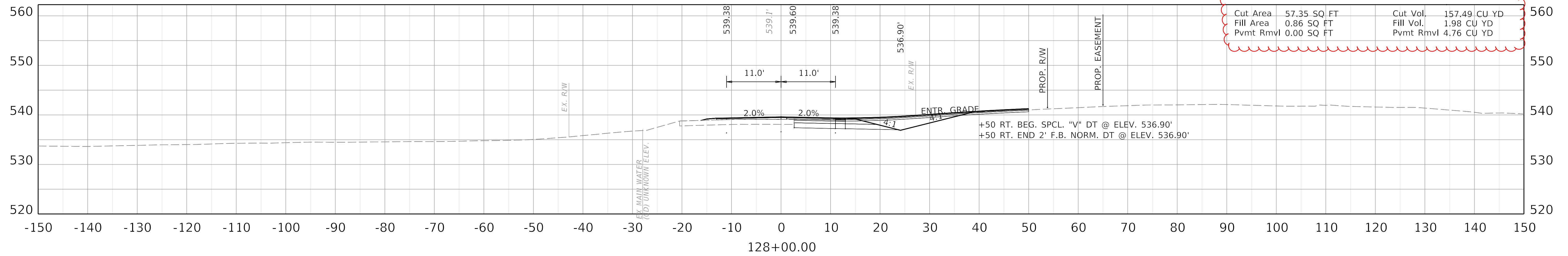

COMMONWEALTH OF KENTUCKY
 DEPARTMENT OF HIGHWAYS

DRAWING TITLE: KY 107 CROSS SECTIONS

HORIZONTAL SCALE
 SCALE: 1" = 10'



STA 127+00.00 TO STA 128+00.00

ITEM NO.
 02-80250.10
 COUNTY OF
 CHRISTIAN
 SHEET NO.
 X014

COORDINATE SYSTEM

Coordinates for horizontal control were obtained from GPS methods and adjusted to the National NAD83/FBN System.

Coordinates are based on State Plane Coordinate System Single Zone and in U.S. Survey Feet.

POINT	DESCRIPTION	GEOMETRIC COORDINATE DATA			STATION	OFFSET
		STATE PLANE COORDINATES				
		NORTH (Y)	EAST (X)	ELEV (Z)		
PC	KY 107	3457185.29	4405362.35		100+00.00	
PI	KY 107	3457356.65	4405411.53		101+78.28	
PT	KY 107	3457529.60	4405454.78		103+56.52	
PC	KY 107	3458205.25	4405623.73		110+52.97	
PI	KY 107	3459069.10	4405839.75		119+43.41	
PT	KY 107	3459883.06	4406200.81		128+29.45	
POB	LOVERS LANE	3459290.87	4405959.83		50+00.00	
PC	LOVERS LANE	3459271.09	4406067.94		51+09.91	
PI	LOVERS LANE	3459260.27	4406127.12		51+70.06	
PT	LOVERS LANE	3459252.31	4406186.74		52+30.19	
POE	LOVERS LANE	3459205.60	4406536.46		55+83.02	

BASIS OF ELEVATIONS

Elevations were derived from GPS methods and are adjusted to the NAVD88 Vertical Datum. Geoid model used was Geoid18.

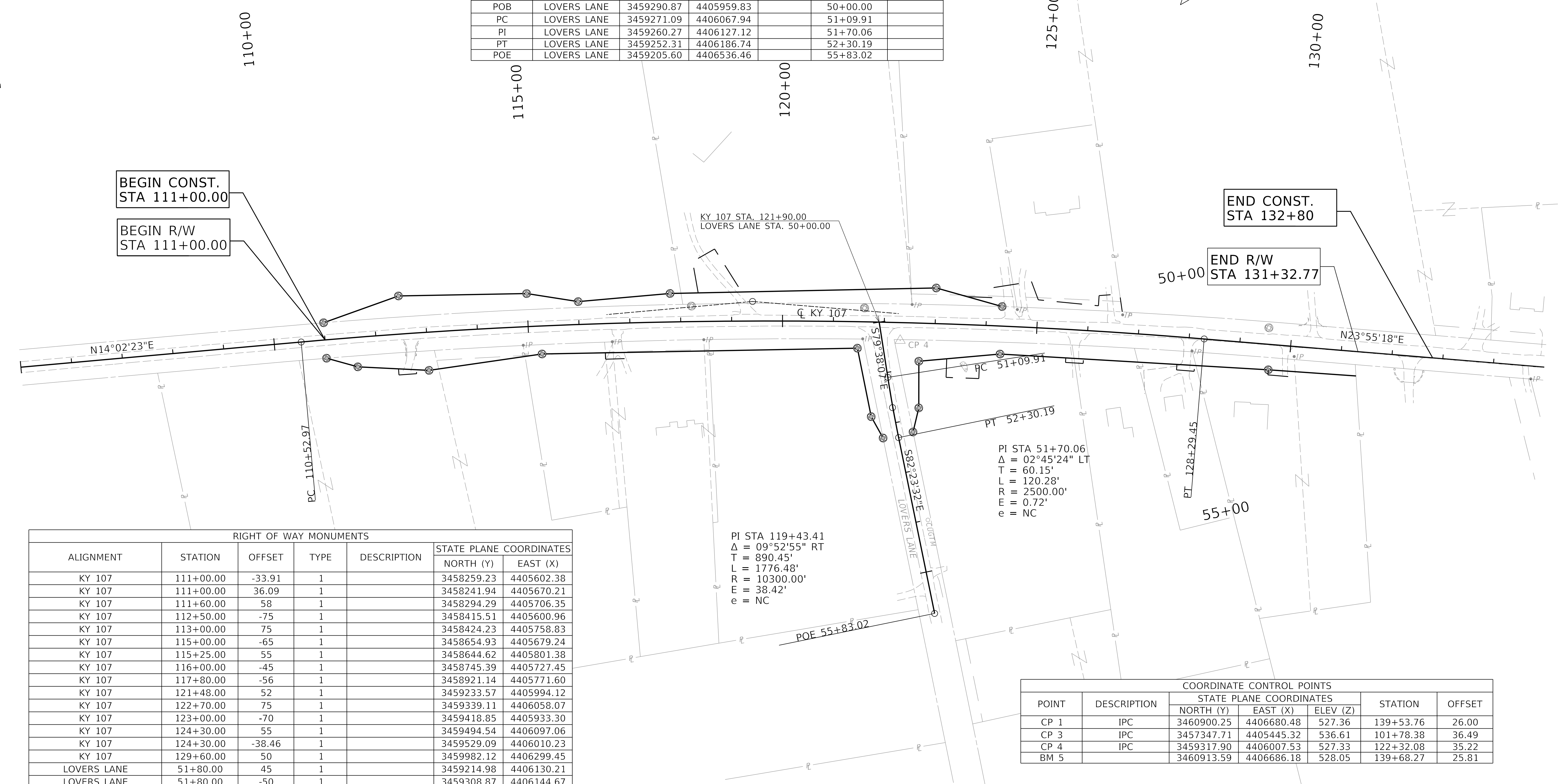
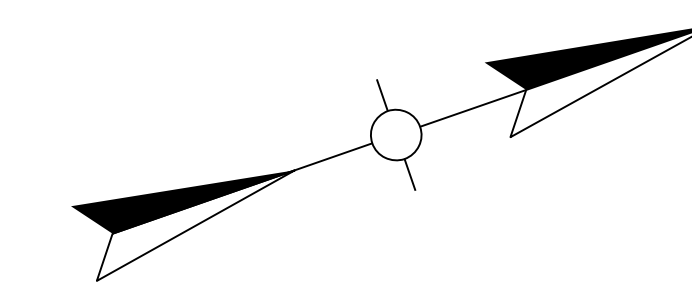

BEGIN CONST.
STA 111+00.00

BEGIN R/W
STA 111+00.00

END CONST.
STA 132+80

END R/W
STA 131+32.77

RIGHT OF WAY MONUMENTS						
ALIGNMENT	STATION	OFFSET	TYPE	DESCRIPTION	STATE PLANE COORDINATES	
					NORTH (Y)	EAST (X)
KY 107	111+00.00	-33.91	1		3458259.23	4405602.38
KY 107	111+00.00	36.09	1		3458241.94	4405670.21
KY 107	111+60.00	58	1		3458294.29	4405706.35
KY 107	112+50.00	-75	1		3458415.51	4405600.96
KY 107	113+00.00	75	1		3458424.23	4405758.83
KY 107	115+00.00	-65	1		3458654.93	4405679.24
KY 107	115+25.00	55	1		3458644.62	4405801.38
KY 107	116+00.00	-45	1		3458745.39	4405727.45
KY 107	117+80.00	-56	1		3458921.14	4405771.60
KY 107	121+48.00	52	1		3459233.57	4405994.12
KY 107	122+70.00	75	1		3459339.11	4406058.07
KY 107	123+00.00	-70	1		3459418.85	4405933.30
KY 107	124+30.00	55	1		3459494.54	4406097.06
KY 107	124+30.00	-38.46	1		3459529.09	4406010.23
KY 107	129+60.00	50	1		3459982.12	4406299.45
LOVERS LANE	51+80.00	45	1		3459214.98	4406130.21
LOVERS LANE	51+80.00	-50	1		3459308.87	4406144.67
LOVERS LANE	52+25.00	30.04	1		3459223.24	4406177.56
LOVERS LANE	52+25.00	-29.96	1		3459282.69	4406185.62

COORDINATE CONTROL POINTS						
POINT	DESCRIPTION	STATE PLANE COORDINATES			STATION	OFFSET
		NORTH (Y)	EAST (X)	ELEV (Z)		
CP 1	IPC	3460900.25	4406680.48	527.36	139+53.76	26.00
CP 3	IPC	3457347.71	4405445.32	536.61	101+78.38	36.49
CP 4	IPC	3459317.90	4406007.53	527.33	122+32.08	35.22
BM 5		3460913.59	4406686.18	528.05	139+68.27	25.81



COMMONWEALTH OF KENTUCKY
DEPARTMENT OF HIGHWAYS

DRAWING TITLE: KY 107 - COORDINATE CONTROL SHEET

HORIZONTAL SCALE
SCALE: 1"=100'

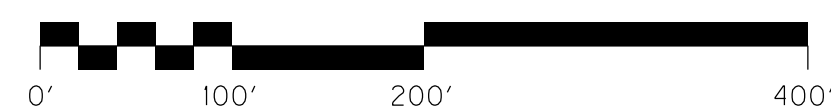

STA 111+00.00 TO 135+00.00

ITEM NO. 02-80250.10 COUNTY OF CHRISTIAN
SHEET NO. R010

COORDINATE SYSTEM

Coordinates for horizontal control were obtained from GPS methods and adjusted to the National NAD83/FBN System.

Coordinates are based on State Plane Coordinate System Single Zone and in U.S. Survey Feet.

POINT	DESCRIPTION	GEOMETRIC COORDINATE DATA			STATION	OFFSET
		STATE PLANE COORDINATES				
		NORTH (Y)	EAST (X)	ELEV (Z)		
PC	KY 107	3457185.29	4405362.35		100+00.00	
PI	KY 107	3457356.65	4405411.53		101+78.28	
PT	KY 107	3457529.60	4405454.78		103+56.52	
PC	KY 107	3458205.25	4405623.73		110+52.97	
PI	KY 107	3459069.10	4405839.75		119+43.41	
PT	KY 107	3459883.06	4406200.81		128+29.45	
POB	LOVERS LANE	3459290.87	4405959.83		50+00.00	
PC	LOVERS LANE	3459271.09	4406067.94		51+09.91	
PI	LOVERS LANE	3459260.27	4406127.12		51+70.06	
PT	LOVERS LANE	3459252.31	4406186.74		52+30.19	
POE	LOVERS LANE	3459205.60	4406536.46		55+83.02	

BASIS OF ELEVATIONS

Elevations were derived from GPS methods and are adjusted to the NAVD88 Vertical Datum. Geoid model used was Geoid18.

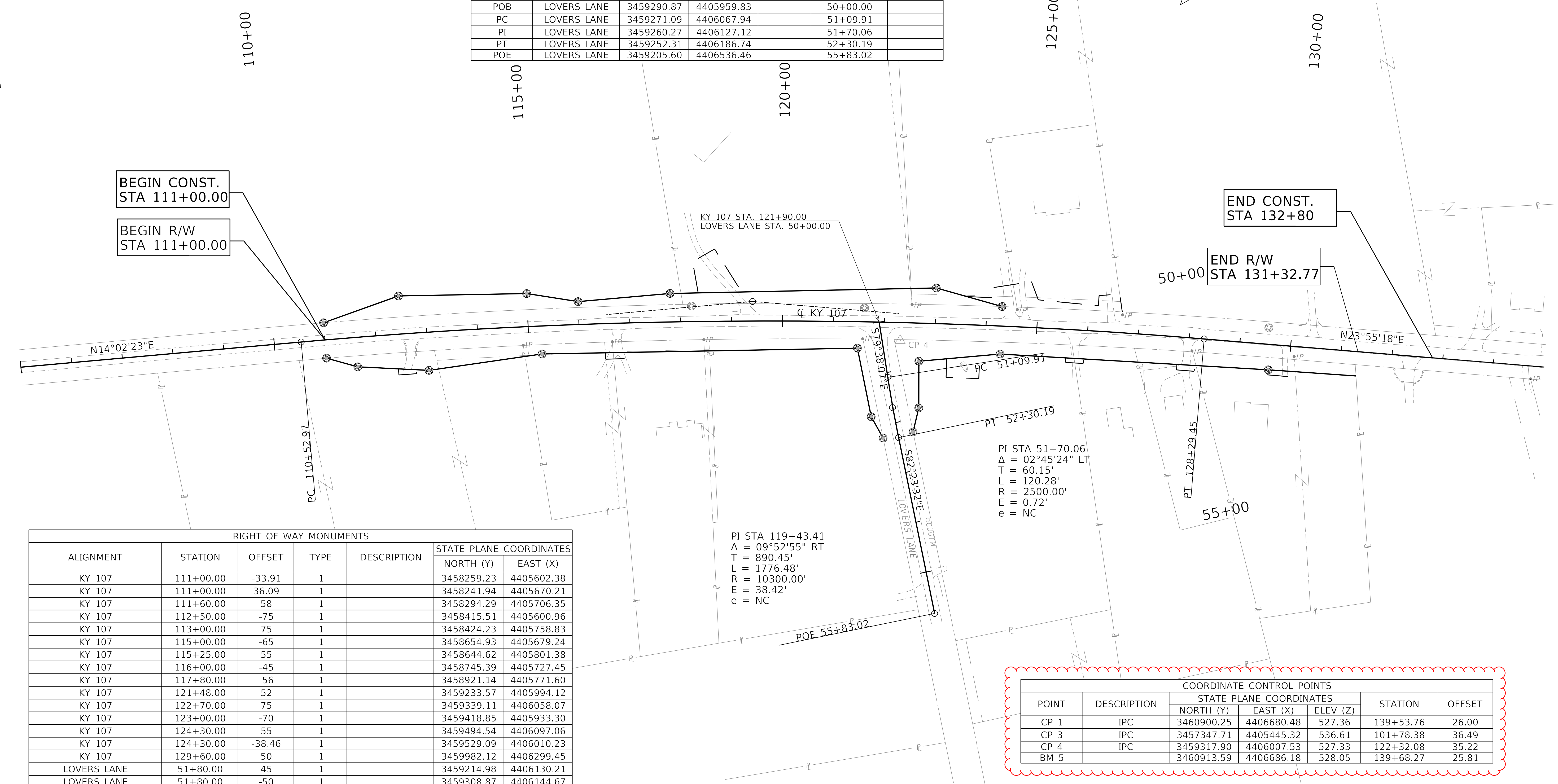
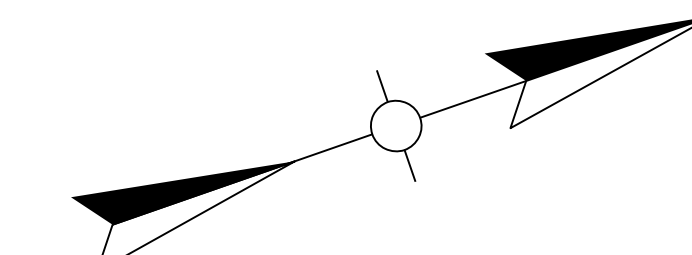

RIGHT OF WAY MONUMENTS						
ALIGNMENT	STATION	OFFSET	TYPE	DESCRIPTION	STATE PLANE COORDINATES	
					NORTH (Y)	EAST (X)
KY 107	111+00.00	-33.91	1		3458259.23	4405602.38
KY 107	111+00.00	36.09	1		3458241.94	4405670.21
KY 107	111+60.00	58	1		3458294.29	4405706.35
KY 107	112+50.00	-75	1		3458415.51	4405600.96
KY 107	113+00.00	75	1		3458424.23	4405758.83
KY 107	115+00.00	-65	1		3458654.93	4405679.24
KY 107	115+25.00	55	1		3458644.62	4405801.38
KY 107	116+00.00	-45	1		3458745.39	4405727.45
KY 107	117+80.00	-56	1		3458921.14	4405771.60
KY 107	121+48.00	52	1		3459233.57	4405994.12
KY 107	122+70.00	75	1		3459339.11	4406058.07
KY 107	123+00.00	-70	1		3459418.85	4405933.30
KY 107	124+30.00	55	1		3459494.54	4406097.06
KY 107	124+30.00	-38.46	1		3459529.09	4406010.23
KY 107	129+60.00	50	1		3459982.12	4406299.45
LOVERS LANE	51+80.00	45	1		3459214.98	4406130.21
LOVERS LANE	51+80.00	-50	1		3459308.87	4406144.67
LOVERS LANE	52+25.00	30.04	1		3459223.24	4406177.56
LOVERS LANE	52+25.00	-29.96	1		3459282.69	4406185.62

COORDINATE CONTROL POINTS						
POINT	DESCRIPTION	STATE PLANE COORDINATES			STATION	OFFSET
		NORTH (Y)	EAST (X)	ELEV (Z)		
CP 1	IPC	3460900.25	4406680.48	527.36	139+53.76	26.00
CP 3	IPC	3457347.71	4405445.32	536.61	101+78.38	36.49
CP 4	IPC	3459317.90	4406007.53	527.33	122+32.08	35.22
BM 5		3460913.59	4406686.18	528.05	139+68.27	25.81

OpenRoads Designer v10.16.2.267

USER: USJL713390

FILE NAME: C:\BMSWSP-US-PW-02\1211622102_80250_10_COORDINATE_CONTROL.DGN

EARTHWORK CALCULATIONS
EMBANKMENT: EMB. - 1,442 CUYD EMB. BENCH - 505 CUYD PVMT. RMVL. - 398 CUYD TOTAL EMB. - 2,345 CUYD
EXCAVATION: COM. - 10,325 CUYD EMB. BENCH - 505 CUYD PVMT. RMVL. - 398 CUYD TOTAL EXC. - 11,228 CUYD
EARTHWORK TOTALS
EXC. AVAILABLE: 8,883 CUYD

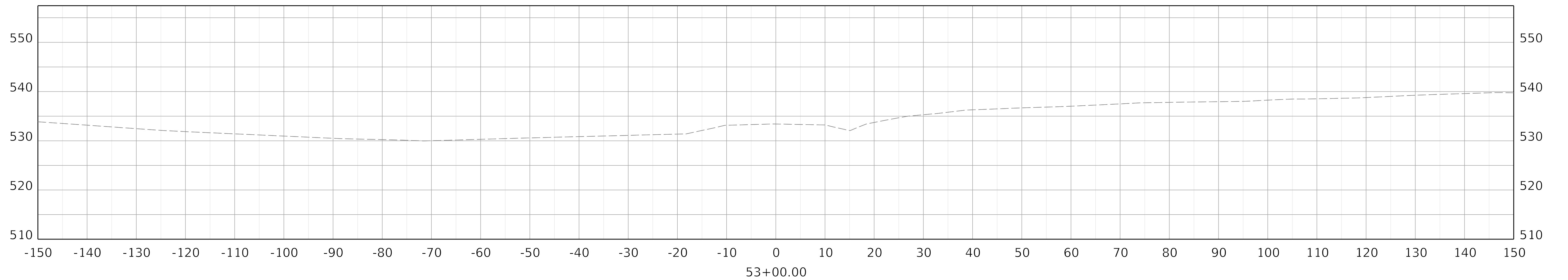

COMMONWEALTH OF KENTUCKY
DEPARTMENT OF HIGHWAYS

DRAWING TITLE: LOVERS LANE CROSS SECTIONS

HORIZONTAL SCALE
SCALE: 1" = 10'

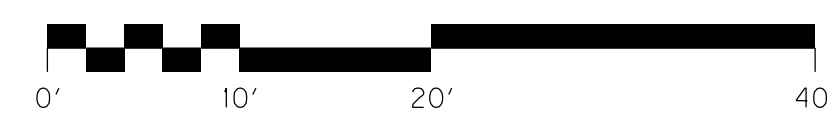

STA 53+00.00

ITEM NO. 02-80250.10 COUNTY OF CHRISTIAN
SHEET NO. X021

EARTHWORK CALCULATIONS	
EMBANKMENT:	
EMB.	- 1,442 CUYD
EMB. BENCH	- 505 CUYD
PVMT. RMVL.	- 398 CUYD
TOTAL EMB.	- 2,345 CUYD
EXCAVATION:	
COM.	- 10,325 CUYD
EMB. BENCH	- 505 CUYD
PVMT. RMVL.	- 398 CUYD
TOTAL EXC.	- 11,228 CUYD
EARTHWORK TOTALS	
EXC. AVAILABLE:	8,883 CUYD

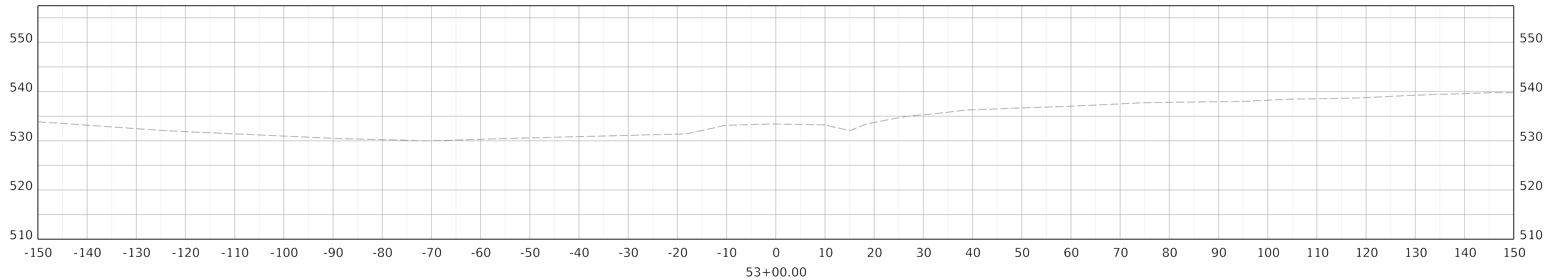

COMMONWEALTH OF KENTUCKY
DEPARTMENT OF HIGHWAYS

DRAWING TITLE: LOVERS LANE CROSS SECTIONS

HORIZONTAL SCALE
SCALE: 1" = 10'



STA 53+00.00

ITEM NO.
02-80250.10 COUNTY OF
CHRISTIAN
SHEET NO.
X021